



Architect Haigh Jamgochian Holds Model of New Moon-Shaped House

Staff Photo by P. A. Gorman Jr.

Jamgochian Designs Moon-Shaped House

By **Kush Loving**
Times-Dispatch
Business Writer

Haigh Jamgochian, the Richmond architect who designs tree-like apartment buildings and offices that look like flying saucers, has come up with a moon-shaped house.

Jamgochian designed the house for Howard H. Hughes, who is best known to Richmond car connoisseurs as Mad Man Dapper Dan the Used Car Man.

Jamgochian says Worley Bros., a local construction firm, is due to begin putting up the \$100,000, 7,000-square-foot building this spring, just west of Boster's Dam on the south bank of the James River.

HUGHES SELLS his cars with the motto: "I'd give them away but my wife won't let me." His house will have everything a successful used car dealer could ask, including enough carports to accommodate four extra-large automobiles.

Jamgochian, who first made headlines here five years ago

with a design for an eight-story, tree-like apartment building, shaped the house like a three-quarter moon.

It will have only two sides, one a rounded section that wraps nearly a full circle around the building before it connects with the two ends of the second side, a curved wall of glass that serves as the house's windows.

This second wall should give Hughes and his family enough windows to feel as if they live in a glass house, but the long rounded wall will stretch out beyond the edges of the window wall and shield it from prying eyes.

THE WINDOW wall will give the major rooms of the house a view up the James River valley, the main requirement Hughes gave Jamgochian when he had him design the house.

"That," said Jamgochian, "was a pretty big requirement, but every room has a view except the maid's room and the guest room."

Besides these two, there will be a family room and a living room, each with a fire-

place, three family bedrooms and a study.

Jamgochian said Hughes asked him to design the house because Hughes' three daughters liked Jamgochian's design for the new Markel Building in Richmond's West End — a round, three-story office building that is coated with sheets of dented aluminum and looks like a flying saucer touching down.

The outside walls of Hughes' house will have a coat of dented copper which will turn green with age and look like the moss-covered boulders that line the nearby river banks.

MOST OF THE inside walls will be prefabricated closets. The storage walls will stop at door height, there will be glass above," Jamgochian said.

He explained that this will allow light from a line of clerestory windows along the top of the walls to filter across the ceilings of the rooms.

Also, he said, inside walls can be taken down and moved on a whim. This, Jamgochian said, makes it possible for a new owner to redesign the interior to his own needs.

It can be done, he went on, because the roof is free-standing.

The elliptical roof will be eight feet thick in the center and will taper to the edge, with the horns of the moon 75 feet from the center.

JAMGOCHIAN SAID the roof should cut construction costs because it will go up on a series of simple columns. The walls will be built underneath, and finally, the interior will be finished. He claims this will prevent delays from bad weather, since the workmen will always be protected from rain.

He also disclosed that the roof, which has a profile like an airplane wing, could have raised one problem. Jamgochian has had to design a strong anchor wall under it, otherwise, he said, a strong wind could blow the roof away. In this house, explained Jamgochian, "anchoring the roof down is more important than holding it up."



Entrance Faces Cherokee Road, and Court Side Faces River

**Building
in America**

**A moon
house
rises over
Richmond**

Haigh Jamgochian, the Richmond, USA, architect who designs tree-like apartment buildings and offices that look like flying saucers, has come up with a moon-shaped house.

Jamgochian designed the house for Howard H. Hughes, who is best known to Richmond car connoisseurs as Mad Man Dapper Dan the Used Car Man.

Jamgochian says Worley Bros, a local construction firm, is due to begin putting up the \$100,000, 7,000-square-foot building this spring just west of Boshers' Dam on the south bank of the James River in Richmond.

Two-sided plan

Hughes sells his cars with the motto: "I'd give them away but my wife won't let me." His house will have everything a successful used dealer could ask, including enough carports to accommodate four extra-large cars.

Jamgochian, who first made headlines with a design for an eight-story, tree-like apartment building,

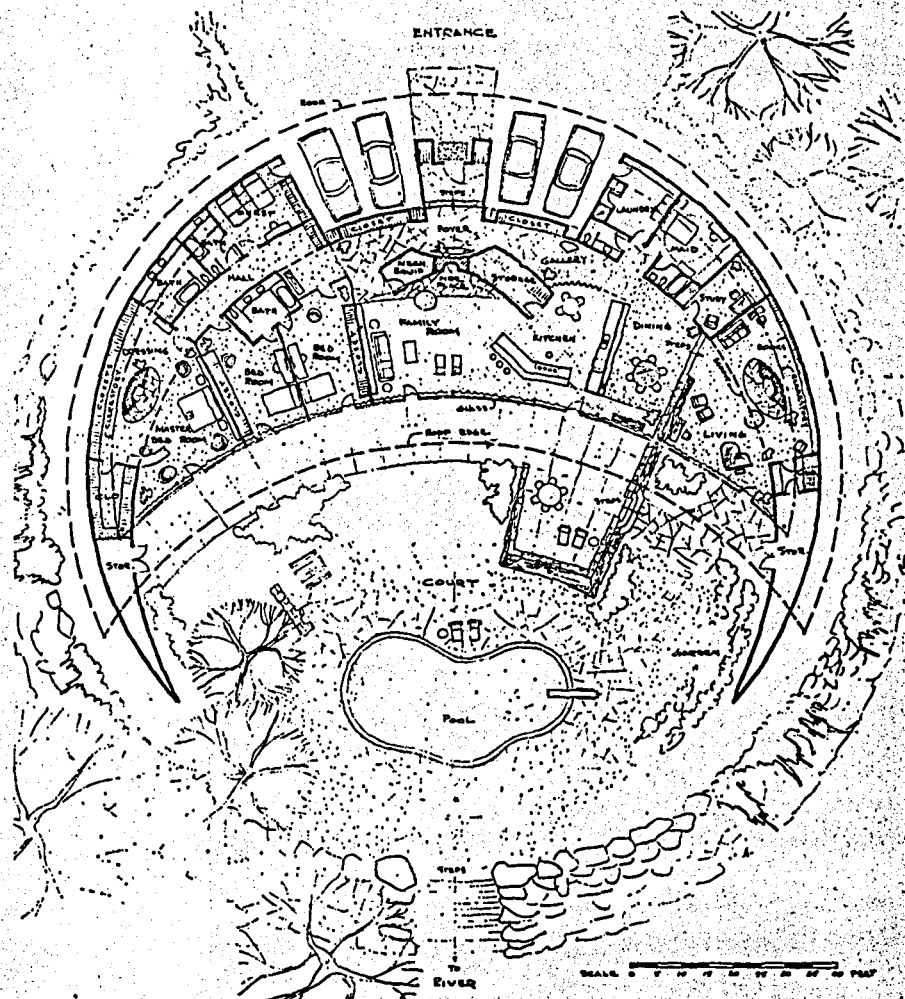

The plan for Haigh Jamgochian's "Moon House".

shaped the house like a three-quarter moon (Building : Lighting : Engineering, August, 1967).

It will have only two sides, one a rounded section that wraps nearly a full circle around the building before it connects with the two ends of the second side, a curved wall of glass that serves as the house's windows.

This second wall should give Hughes and his family enough windows to feel as if they live in a glass house, but the long rounded wall will stretch out beyond the edges of the window wall and shield it from prying eyes.

The window wall will give the major rooms of the house a view up the James River valley, the main requirement Hughes gave Jamgochian when he had him design the house.

"That," said Jamgochian, "was a pretty big requirement, but every room has a view except the maid's room and the guest room."

Daughter's request

Besides these two, there will be a family room and a living room, each with a fireplace, three family bedrooms and a study.

Jamgochian said Hughes asked him to design the house because Hughes' three daughters liked Jamgochian's design for the new Markel building in Richmond's West End — a round, three-story office building that is coated with sheets of dented aluminium and looks like a flying saucer touching down (B:L:E, September).

The outside walls of Hughes' house will have a coat of dented

• Continued Page 28

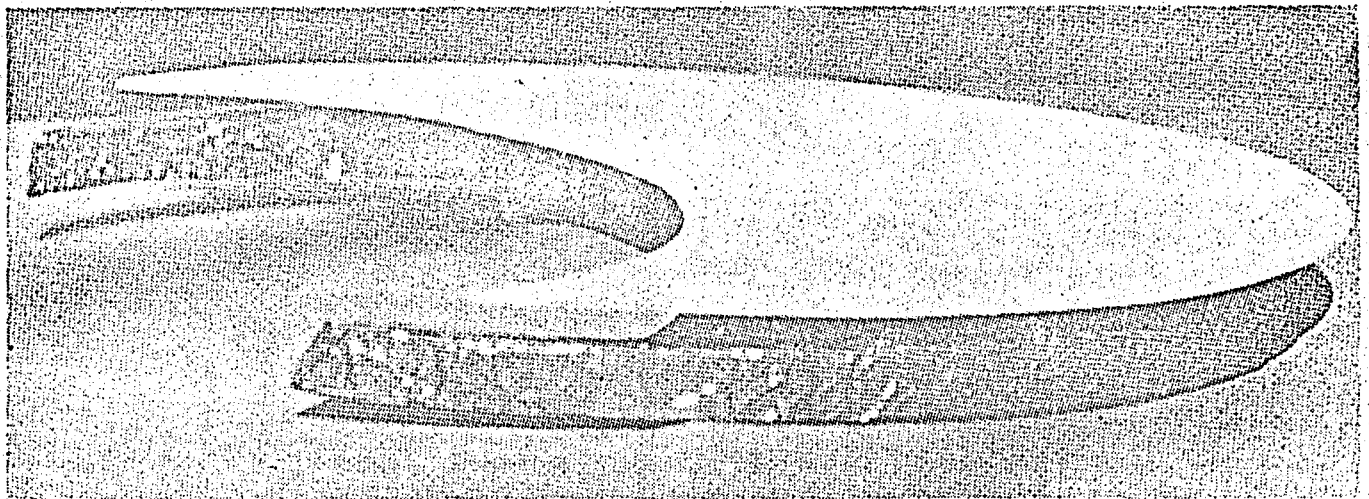

PROCEDURE FOR
APPLYING COPPER
EXTERIOR SIDING

BUSBY'S House
2/23/67

ABOVE: The simple model of the "Moon House" Jamgochian designed for a Richmond used-car dealer.

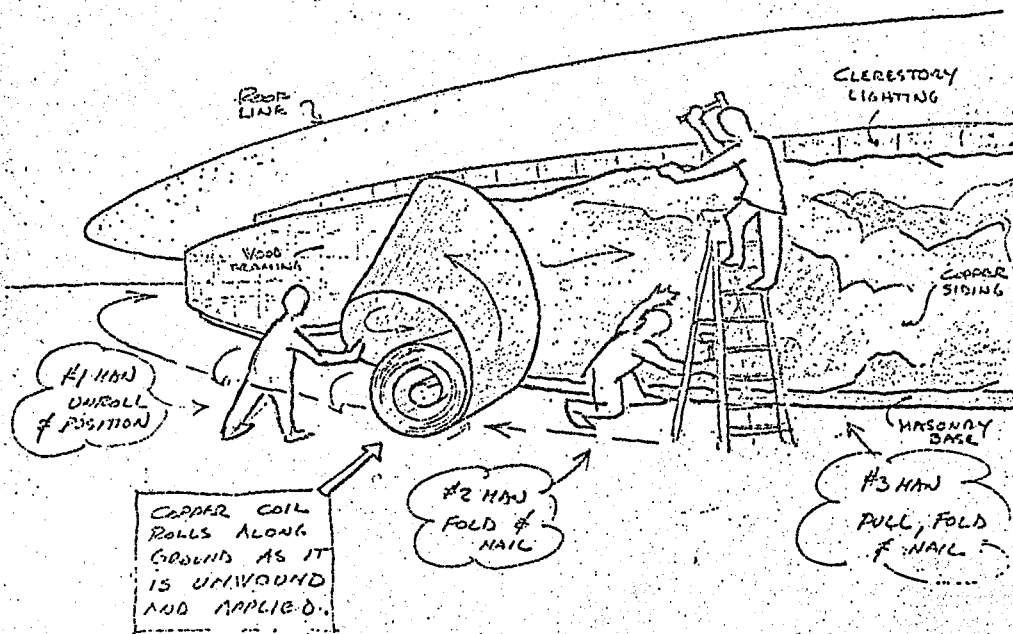

LEFT: Another ingenious Jamgochian sketch illustrating the application of the copper cladding.

● From Page 27
copper which will turn green with age and look like the moss-covered boulders that line the nearby river banks.

Walls can be moved

Most of the inside walls will be prefabricated closets. "The storage walls will stop at door height; there will be glass above," Jamgochian said.

He explained that this will allow light from a line of clerestory windows along the top of the walls to filter across the ceilings of the rooms.

Also, he said, inside walls can be taken down and moved on a whim. This, Jamgochian said, makes it possible for a new owner to redesign the interior to his own needs.

It can be done, he went on, because the roof is free-standing.

A roof like a wing

The elliptical roof will be eight feet thick in the centre and will taper to the edge, with the horns of the moon 75 feet from the centre.

Jamgochian said the roof should cut construction costs because it

will go up on a series of simple columns. The walls will be built underneath, and finally, the interior will be finished. He claims this will prevent delays from bad weather, since the workmen will always be protected from rain.

He also disclosed that the roof, which has a profile like an airplane wing, could have raised one problem. Jamgochian has had to design a strong anchor wall under it, otherwise, he said, a strong wind could blow the roof away. In this house, explained Jamgochian, "anchoring the roof down is more important than holding it up."